



PUZ

PLAN URBANISTIC ZONAL COMUNA GIUVARASTI, JUD. OLT

LEGENDA

-  Limita zonei studiate
-  Limita din cadastru a terenului studiat.
S Teren = 9961.00 mp
-  Circulație carosabilă/pietonala - cale de acces
-  Teren extravilan - zona destinata agriculturii

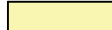
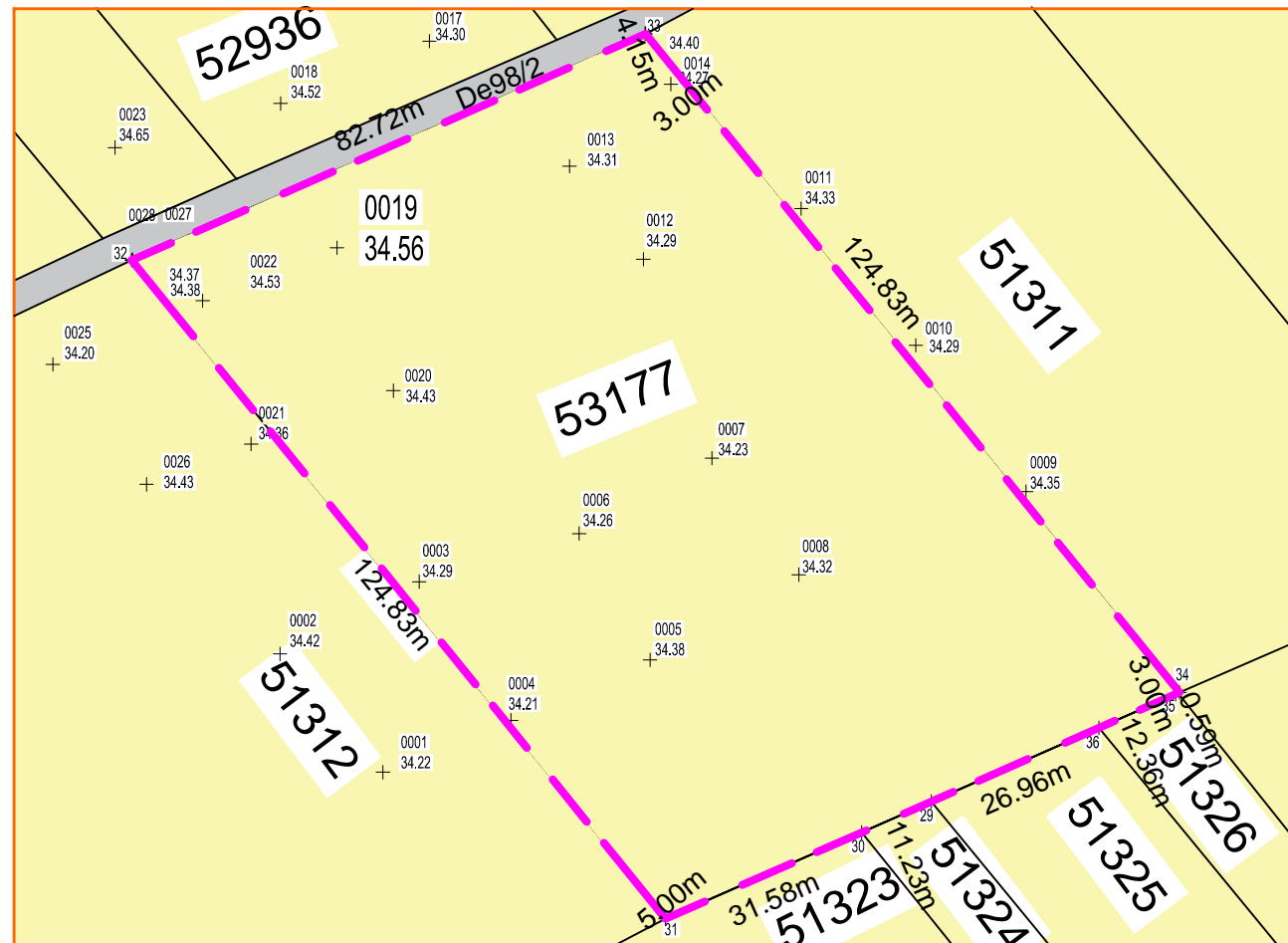

NR.CAD 53177

Nr. Pct.	Coordonate pct.de contur		Lungimi laturi D(i,i+1)
	E [m]	N [m]	
29	474967.743	256434.681	11.23
30	474957.463	256430.155	31.58
31	474928.559	256417.429	124.83
32	474849.926	256514.384	82.72
33	474925.633	256547.715	124.83
34	475004.265	256450.760	0.59
35	475003.723	256450.521	12.36
36	474992.415	256445.543	26.96
S= 9961 mp			

S.C. ANGELA BUȘCĂ ARCHITECTURE S.R.L.
CUI 39831471

SPECIFICATIE	NUME	SEMNATURA	Scara:
SEF PROIECT	c.arh.urb. Angela Bușcă		1:1000
PROIECTANT	c.arh.urb. Angela Bușcă		Data:
DESENAT	c.arh.urb. Angela Bușcă		2020

Beneficiari:	SC PRODACVA CARISMA SRL ORAS CORABIA, STR. CUZA VODA, NR.84, JUD. OLT	Proiect nr. 16 / 2020
--------------	--	--------------------------

Titlu proiect: AMENAJARE IAZ PISCICOL PRIN EXTRAGEREA PIETRISULUI SI NISIPULUI COM. GIUVARASTI, T. 7 / 3 , P50 / 2, 52 / 2, 53 / 2, 54 / 2, 54 / 1 / 2,	Faza: PUZ
---	--------------

Titlu plansa: SITUATIA EXISTENTA - PLAN DE SITUATIE	Plansa nr. U1
--	------------------