



LEGENDA:

— LIMITA ZONA STUDIATA PRIN PUZ S=29087.74 mp
 - - - - - LIMITA TEREN CE A GENERAT PUZ S=20740.00 mp

DOMENIU PUBLIC
 ZONA CIRCULATI CAROSABILE EXISTENTE
 TERENURI VECINE CARE APARTIN ZONEI STUDIATE PRIN PUZ
 ZONA UNITATI AGRICOLE
 PROPRIETATE PRIVATA PERSOANE FIZICE SI JURIDICE

TEREN CE APARTINE SC EURODIVAL SRL
 ZONA PROPUSA PENTRU AGREMENT SI PRODUCTIE
 IAZ PISCICOL CU EXTRACTIE DE BALAST
 S=17210.22 mp

ZONA DE PROTECTIE
 (SPATII PLANTATE CU GAZON SI ARBORI)
 S=3529.78 mp

(EX) SIMBOL UNITATE TERITORIALA DE REFERINTA

(A) ZONA UNITATI AGRICOLE
 (C) ZONA CIRCULATII EXISTENTE

(SP) + (P) ZONA AGREMENT SI PRODUCTIE

SENSURI AUTO

ACCESSE AUTO

BILANT TERITORIAL:

S.T.=20740.00mp
EXISTENT PROPUS
 AC=0.00mp AC=17210.22mp
 AD=0.00mp AD=17210.22mp
 P.O.T ex=0.00% P.O.T propusa=82.98%
 C.U.T ex=0.00 C.U.T propusa=0.82

INDICATORII URBANISTICI PROPUZI
 P.O.T max propus prin PUZ=82%
 C.U.T max propus prin PUZ=0.85

COORDONATE STEREO IAZ PISCICOL PROPUS

Y=444898.771 X=322744.236
 Y=445025.639 X=322838.693
 Y=445026.608 X=322839.047
 Y=445027.571 X=322839.225
 Y=445028.695 X=322839.233
 Y=445029.600 X=322839.084
 Y=445030.602 X=322838.742
 Y=445031.471 X=322838.269
 Y=445032.264 X=322837.646
 Y=445032.934 X=322836.910
 Y=445065.219 X=322761.255
 Y=445071.767 X=322745.913

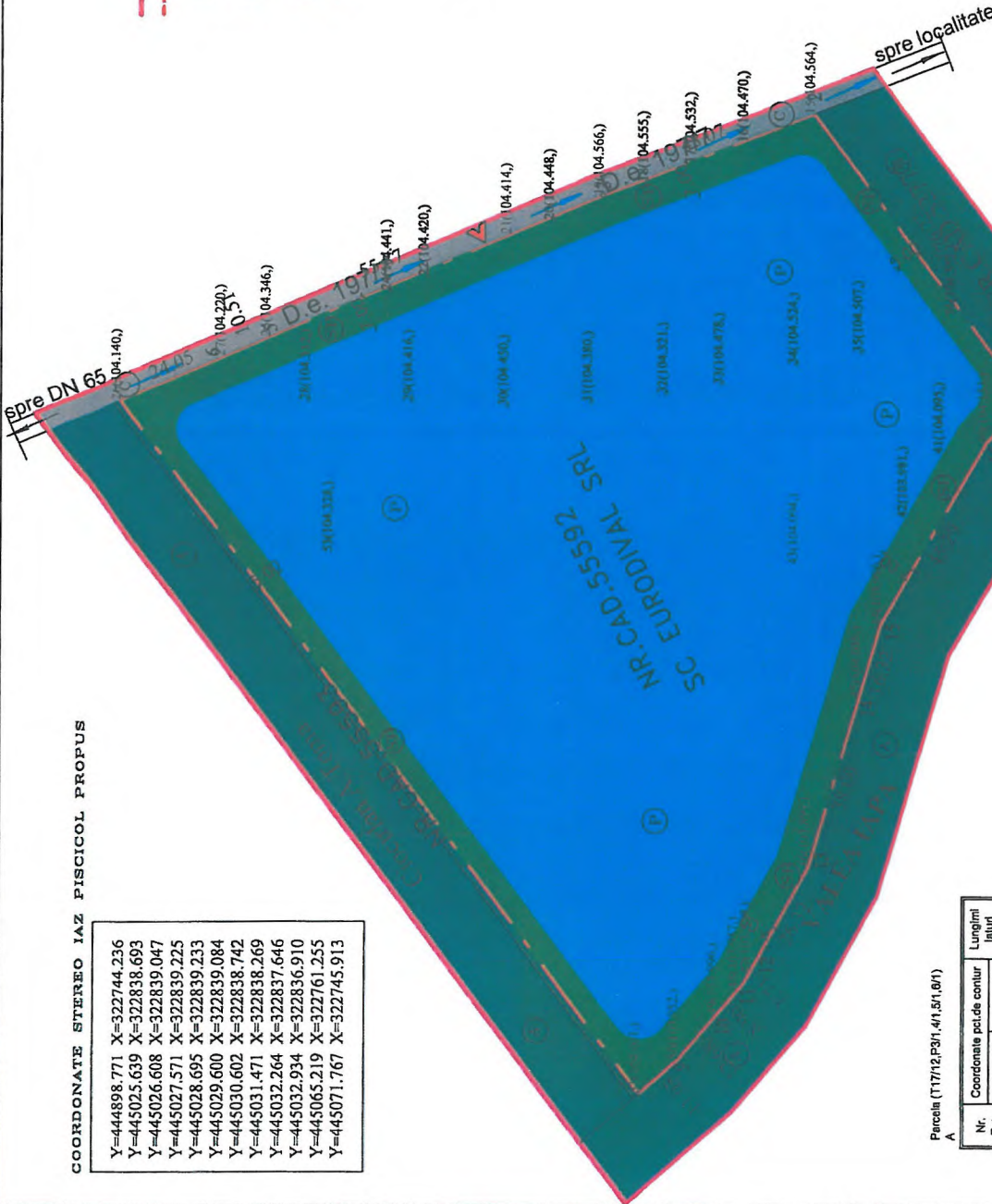

Parcela (171712.P301, 411,51,611)

Nr. Pct.	Coordonate pct.de conlur	Lungimi	Iluzii	Dl(Kr1)
	X [m]	Y [m]		
26	322851.415	446034.355	24.052	
27	322826.283	445043.795	10.514	
25	322819.823	445047.922	55.874	
21	322768.233	445069.852	21.405	
19	322748.546	445078.254	48.071	
15	322703.889	445085.536	76.285	
39	322688.166	446034.355	12.741	
40	322686.555	446024.774	45.288	
44	322689.283	444885.590	18.316	
45	322693.874	444889.539	37.997	
46	322704.612	444833.491	26.324	
47	322717.260	444870.421	1.708	
48	322718.113	444908.924	8.895	
49	322723.876	444802.146	12.678	
50	322732.089	444882.460	11.028	
51	322740.374	444885.212	185.940	
SC(1712.P301, 411, 51, 611)			P=88.086m	

**PROIECIANT GENERAL
 S.C.PIRAMID PROIECT S.R.L.**

CUI RO13406974
 Cod fiscal: J28/186/2000
 SLATINA, JUD. OLT
 Tel: 0249/430111 mobil: 0765945081-0766454748

Sef proiect arh. Ionescu A.

Proiectat arh. Ionescu A.

Desenat: ing. Florescu D.

Benef: SC EURODIVAL SRL
 COM. SLATIOARA, JUD. OLT

Den: STUDIU DE OPORTUNITATE PENTRU CONSTRUIRE IAZ PISCICOL CU EXTRACTIE DE BALAST COMUNA SLATIOARA, T.17/12 SI P.3/1.P.4/1 P.5/1.P.6/1.JUD. OLT

Denumire Plan: REGLEMENTARI URBANISTICE SI TUZII PROPUSA

Nr. Pr. 189

Faza: STUDIU

Nr. Pl. A.06

Sc:1:1000 Data:05/08/2022