

PUZ (PLAN URBANISTIC DE ZONA)  
MUN. SLATINA, T 34/1, P 20, JUD. OLT  
SITUATIA PROPUSA - REGLEMENTARI

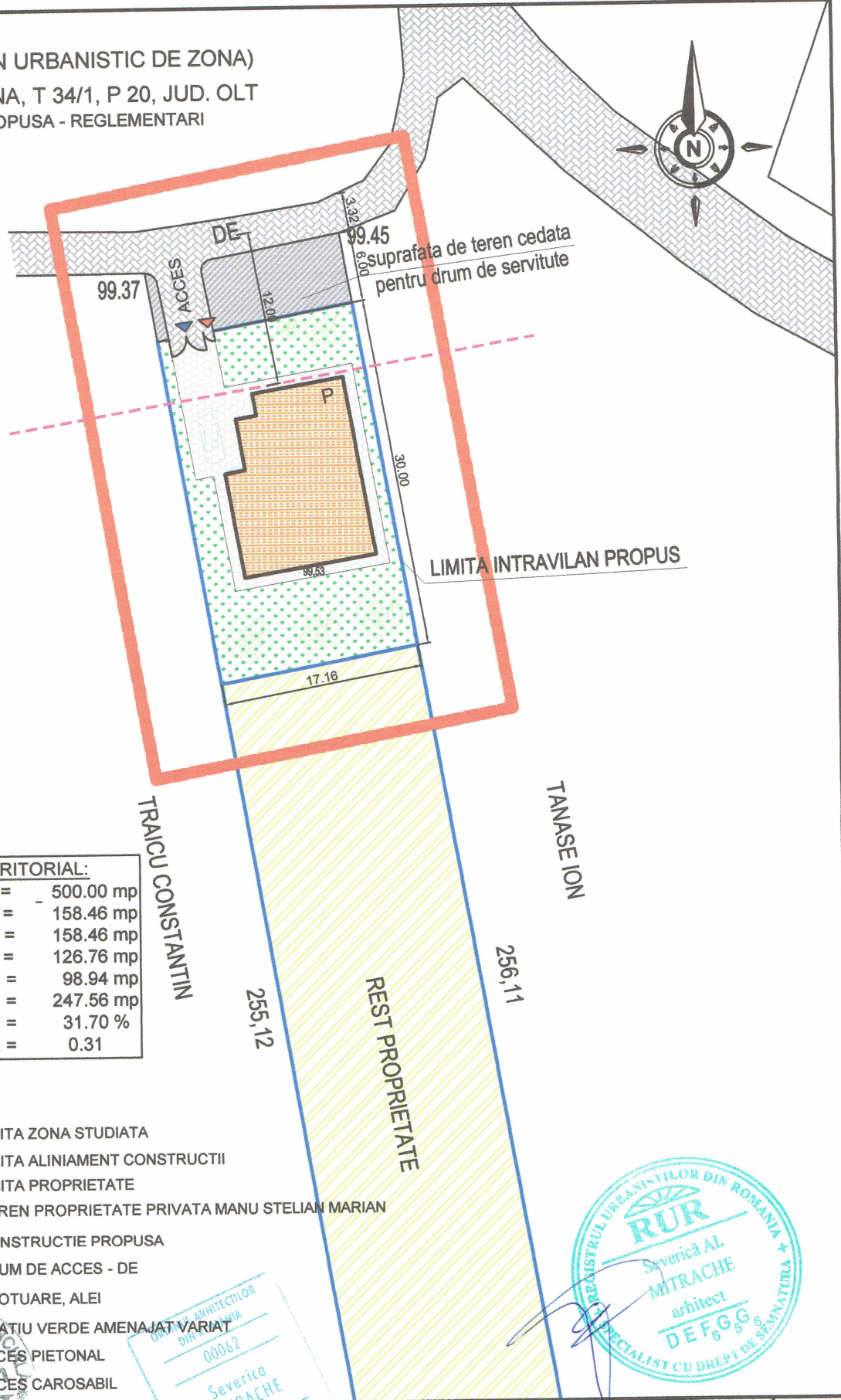
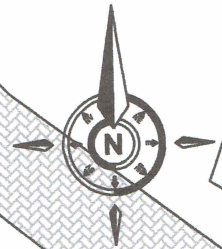

BILANT TERITORIAL:		
S teren	=	500.00 mp
S construita	=	158.46 mp
S desfasurata	=	158.46 mp
S utila	=	126.76 mp
S trotuare+alei	=	98.94 mp
S spatii verzi	=	247.56 mp
P.O.T.	=	31.70 %
C.U.T.	=	0.31

**LEGENDA**

- LIMITA ZONA STUDIATA
- LIMITA ALINIAMENT CONSTRUCTII
- LIMITA PROPRIETATE
- TEREN PROPRIETATE PRIVATA MANU STELIAN MARIAN
- CONSTRUCTIE PROPUSA
- DRUM DE ACCES - DE
- TROTUARE, ALEI
- SPATIU VERDE AMENAJAT VARIAT
- ACCES PIETONAL
- ACCES CAROSABIL

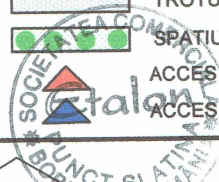

			230103 Slatina, str. Varianta Oltuz, nr.5 Tel/Fax: 0249 432 830 E-mail: etalon.slatina@yahoo.com J28/1627/1994, C.U.I.R 6759329		BENEFICIAR: <b>MANU STELIAN MARIAN</b> MUN. SLATINA, STR. DOROBANTI, NR. 23, BL. 23, SC. A, AP. 9, JUD. OLT		PR. NR. <b>1967</b>
SPECIFICATIE	NUME	SEMNTURA	SCARA	TITLUL PROIECTULUI:		FAZA	
SEF PROIECT	ARH SEVERICA MITRACHE		1:200	<b>CONSTRUIRE LOCUINTA PARTER</b>		P.U.Z.	
PROIECTAT	ARH SEVERICA MITRACHE		DATA	MUN. SLATINA, T 34/1, P 20, JUD. OLT		PL. NR.	
DESENAT	ING ALEXANDRU MITRACHE		DECEMBRIE 2013	TITLUL PLANSEI: <b>SITUATIA PROPUSA - REGLEMENTARI</b>		U3	